

AIR PREPARATION UNITS - ACCESSORIES

Accessories - CLAMPS

Cat No APA - 02 - C

CLAMP for FILTER, LUBRICATOR

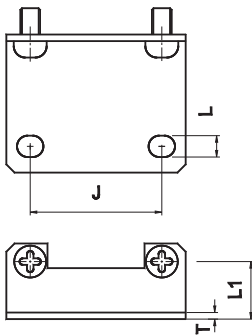

Adoptable to Model series		J	L	L1	T	Ordering No.
F13, L13	Inch	1.102	0.216	0.551	0.079	A2C31
	mm	28	5.5	14	2	
F14, L14	Inch	1.575	0.256	0.69	0.079	A2C32
	mm	40	6.5	17.5	2	
F15, L15	Inch	2.165	0.335	0.87	0.079	A2C33
	mm	55	8.5	22	2	
F17, L17	Inch	2.60	0.43	1.30	0.20	A2C34
	mm	66	11	33	5	



How to order :- Mention the ordering number required

Example :- Clamp for 3/8 Filter, Lubricator series F14, L14 - Ordering no : A2C32

CLAMP for REGULATOR

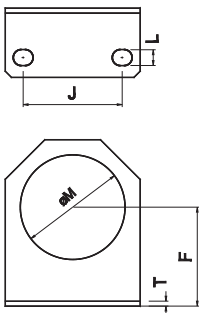

Adoptable to Model series		ØM	F	L	J	T	Ordering No.
R13, FRC13	Inch	1.2	1.181	0.216	1.102	0.079	A2C01
	mm	30.5	30	5.5	28	2	
R14, FRC14	Inch	1.673	1.575	0.256	1.575	0.079	A2C02
	mm	42.5	40	6.5	40	2	
R15, FRC15	Inch	2.067	1.968	0.335	2.165	0.079	A2C03
	mm	52.5	50	8.5	55	2	
R17, FRC17	Inch	2.067	2.756	0.433	2.598	0.197	A2C04
	mm	52.5	70	11	66	5	



How to order :- Mention the ordering number required

Example :- Clamp for 3/8 Regulator series R14, FRC 14 - Ordering no : A2C02

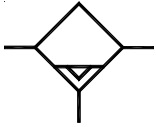

AUTO DRAIN VALVE

Series NA1

Cat No APA - 02 - C

**AUTO DRAIN VALVE suitable for Filter Series F13, F14, F15 and F17
Filter Regulator combination series FRC13, FRC14, FRC15 and FRC17**

Features

- Individual unit (Externally mountable)
- Low operating pressure
- Compact size
- Elegant design and finish
- Long life

Function

These Auto drain units are externally mountable on G1/4, 3/8, 1/2, 3/4 and 1/2 size Filters and FRC units.

As the condensed water collects in the drain unit, the float moves up and drains the water.

The condensate water can also be drained manually.

A plastic tube can be fitted at the bottom of the auto drain unit to take the drained water away from the unit.



Technical Specifications

Ordering No.	A2D01	A2D02	A2D03
Size	NPT 1/4 (G1/4)	NPT 3/8 (G3/8)	NPT 1/2 (G1/2)
Medium	Compressed air		
Operating pressure	28 - 140 psi (2 - 10 bar)		
Ambient Temperature	41° - 140° F (5° - 60° C)		
Installation	Vertical (as in the picture)		
Materials of construction	Aluminium, Brass, Acetal, Stainless steel, Nitrile		

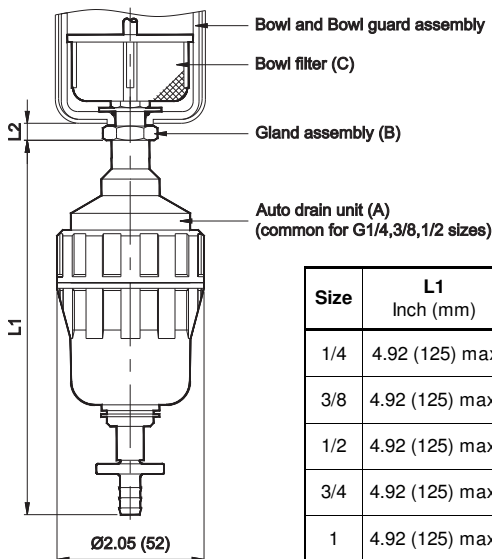

Size	L1 Inch (mm)	L2 Inch (mm)	Auto drain unit (A)	Gland Assy. (B)	Bowl filter (C)	Model (A+B+C)
1/4	4.92 (125) max	0.28 (7)	NA100	LA2003	752002	A2D01
3/8	4.92 (125) max.	0.28 (7)	NA100	LA2004	752003	A2D02
1/2	4.92 (125) max.	0.28 (7)	NA100	LA2005	752004	A2D03
3/4	4.92 (125) max.	0.28 (7)	NA100	LA2005	752004	A2D03
1	4.92 (125) max.	0.28 (7)	NA100	LA2005	752004	A2D03



Note

When ordered as A2D01, Auto drain unit with a Gland assembly and a Bowl filter suitable for NPT1/4 (G1/4) Filter or FRC will be supplied. The Auto drain unit can be ordered separately. Ordering no: NA100

Subject to change

AIR PREPARATION UNITS - ACCESSORIES

Accessories - for Modular construction

Cat No APA - 02 - C

SPACER

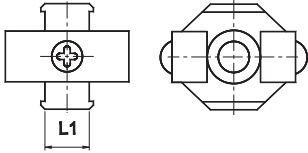

Adoptable to Model series		L1	Ordering No.
F13, L13, R13, FRC13	Inch	0.472	A2S01
	mm	12	
F14, L14, R14, FRC14	Inch	0.551	A2S02
	mm	14	
F15, L15, R15, FRC15	Inch	0.63	A2S03
	mm	16	
F17, R17, L17, FRC17	Inch	0.59	A2S04
	mm	15	



How to order :- Mention the ordering number required

Example :- Spacer for 3/8 Filter, Regulator, Lubricator series F14, R14, L14 - Ordering no : A2S02

T SPACER

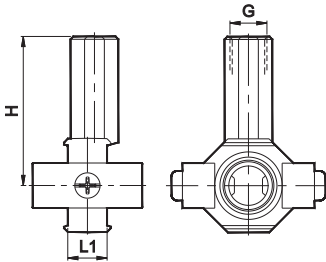

Adoptable to Model series	G		L1	H	Ordering No.
F13, R13, L13, FRC13	NPT1/8	Inch	0.472	1.967	A2T04
	G1/8	mm	12	50	A2T01
F14, R14, L14, FRC14	NPT1/4	Inch	0.551	2.087	A2T05
	G1/4	mm	14	53	A2T02
F15, R15, L15, FRC15	NPT3/8	Inch	0.63	2.047	A2T06
	G3/8	mm	16	52	A2T03



How to order :- Mention the ordering number required

Example :- T Spacer for 3/8 Filter, Regulator, Lubricator, FRC Series F14, R14, L14, FRC14 : Ordering no : A2T02

PIPING ADAPTOR

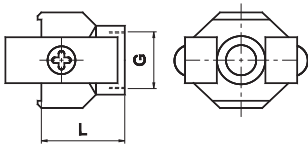

Adoptable to Model series	G		L	Ordering No.
F13, L13, R13, FRC13	NPT 1/4	Inch	1.063	A2P04
	G1/4	mm	27	A2P01
F14, L14, R14, FRC14	NPT 3/8	Inch	1.142	A2P05
	G3/8	mm	29	A2P02
F15, L15, R15, FRC15	NPT 1/2	Inch	1.26	A2P06
	G1/2	mm	32	A2P03
F17, R17, L17, FRC17	NPT 3/4	Inch	1.38	A2P09
	G3/4	mm	35	A2P07
	NPT 1	Inch	1.38	A2P10
	G1	mm	35	A2P08



How to order :- Mention the ordering number required

Example :- Piping Adaptor for 3/8 Filter, Regulator, Lubricator series F14, R14, L14 - Ordering no : A2P02

Subject to change

AIR PREPARATION UNITS - ACCESSORIES

Accessories - for Modular construction

Cat No APA - 02 - C

WALL MOUNTING BRACKET

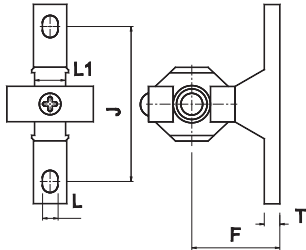

Adoptable to Model series		L1	J	L	F	T	Ordering No.
F13, L13, R13, FRC13	Inch	0.472	1.968	0.275	1.378	0.275	A2W01
	mm	12	50	7	35	7	
F14, L14, R14, FRC14	Inch	0.551	2.756	0.275	1.772	0.275	A2W02
	mm	14	70	7	45	7	
F15, L15, R15, FRC15	Inch	0.63	3.543	0.354	2.165	0.354	A2W03
	mm	16	90	9	55	9	
F17, R17, L17, FRC17	Inch	0.59	3.94	0.472	2.76	0.39	A2W04
	mm	15	100	12	70	10	



How to order :- Mention the ordering number required

Example :- Wall mounting Bracket for 3/8 Filter, Regulator, Lubricator series F14, R14, L14 : Ordering no : A2W02

X SPACER ASSEMBLY - Mountable between FRL, FRC modular units.

- 4 way connector

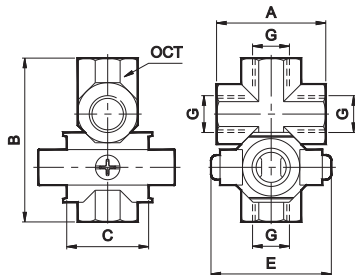

Adoptable to Model series	G		A	B	C	E	OCT	Ordering No.
FRLM13, FRCLM13	NPT1/4	Inch	1.58	2.36	1.18	1.77	0.87	A2M04
	G1/4	mm	40	60	30	45	22	A2M01
FRLM14, FRCLM14	NPT3/8	Inch	1.77	2.62	1.38	2.17	1.06	A2M05
	G3/8	mm	45	66.5	35	55	27	A2M02
FRLM15, FRCLM15	NPT1/2	Inch	2.20	3.27	1.58	2.76	1.18	A2M06
	G1/2	mm	56	83	40	70	30	A2M03



How to order :- Mention the ordering number required

Example :- X Spacer assembly for 3/8 FRLM, FRCLM Series : Ordering no : A2M02

KIT FOR MODULAR CONSTRUCTION

For Modular construction, order accessories as given below

	Wall mounting bracket	Piping Adaptor
FRCLM	1	2
FRLM	2	2

AIR PREPARATION UNITS - ACCESSORIES

Accessories - Pressure Gauge

Cat No APA - 02 - C

PRESSURE GAUGE

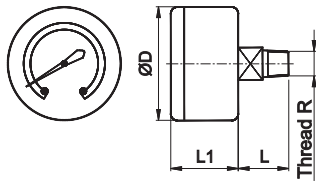

Thread R	Pressure range in psi (bar)	Adoptable to Model series		ØD	L	L1	Ordering No.
NPT1/8 (R1/8)	0 - 57 (0 - 4)	R13, R14, R15, FRC13, FRC14, FRC15	Inch	1.654	0.748	0.984	A2G04 (A2G01)
	0 - 140 (0 - 10)					A2G05 (A2G02)	
	0 - 232 (0 - 16)		mm	42	19	25	A2G06 (A2G03)
NPT1/4 (R1/4)	0 - 57 (0 - 4)	R17, FRC17	Inch	1.969	0.945	1.102	A2G13 (A2G07)
	0 - 140 (0 - 10)					A2G14 (A2G08)	
	0 - 232 (0 - 16)		mm	50	24	28	A2G15 (A2G09)



How to order :- Mention the ordering number required

Example :- 1/8 Pressure Gauge for Regulator with Pressure range 0 - 140 psi : Ordering no : A2G02

PANEL MOUNTING PRESSURE GAUGE

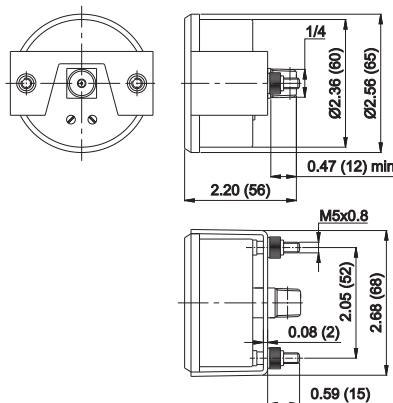

Thread R	Pressure range in psi (bar)	Adoptable to Model series	Ordering No.
1/4	0 - 140 (0 - 10)	R17, FRC17	A2GP08



How to order :- Mention the ordering number required

Example :- 1/4 Pressure Gauge for Regulator with Pressure range 0 - 140 psi : Ordering no : A2GP08