

BSM ROTARY GEAR PUMPS

B-SERIES

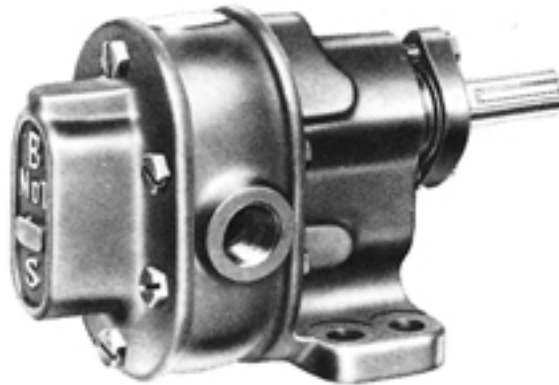

FT. MTD. PUMP

B-Series pumps are a good choice for a variety of recirculating, mixing, and transfer applications. Typical pumped liquids include solvents, resins, and petroleum products. These pumps are well suited for light, medium, and intermittent service.

Design: Drive speeds to 900 rpm; discharge pressures to 200 psi; flow rate to 26.8 gpm; foot or flange mounted; with or without integral relief valve.

Material: Cast Iron casings with precision machined, heat treated gears and case hardened shafts. Pumps are also available in Ductile Iron and Carbon Steel.

Bearings: Replaceable iron sleeve bearings. Also available with carbon graphite or bronze bearings.

Seal: Compression packing with adjustable gland. Also available with self adjusting mechanical seal or lip seal. Mechanical seal and lip seals available with different elastomers.

Lubrication: Self lubricating using the pumped liquid. Also available for handling non-lubricating liquids.

Rotation: Pumps may be operated in either direction. Discharge is always on the side of the pump toward which the top of the shaft rotates.

Liquid Viscosities: 32 ssu to 100,000 ssu. Adaptable for handling liquids from water soluble to molten lead.

Suction Lift: Up to 28 Hg / 31 feet depending on the type of liquid being pumped.

Drive Options: A-Drive (pump connected to c-face motor with adapter bracket and coupling); D-Drive (pump coupled to motor mounted on baseplate); GR-Drive (pump coupled to gear reducer coupled to motor mounted on baseplate); B-Drive (pump and motor connected by V-belt and pulleys mounted on baseplate).

Accessories: Repair Kits; Gear Sets; Bearing Kits; and Seal Kits. Refer Section 13.

BSM ROTARY GEAR PUMPS

DIMENSIONAL DATA B-SERIES

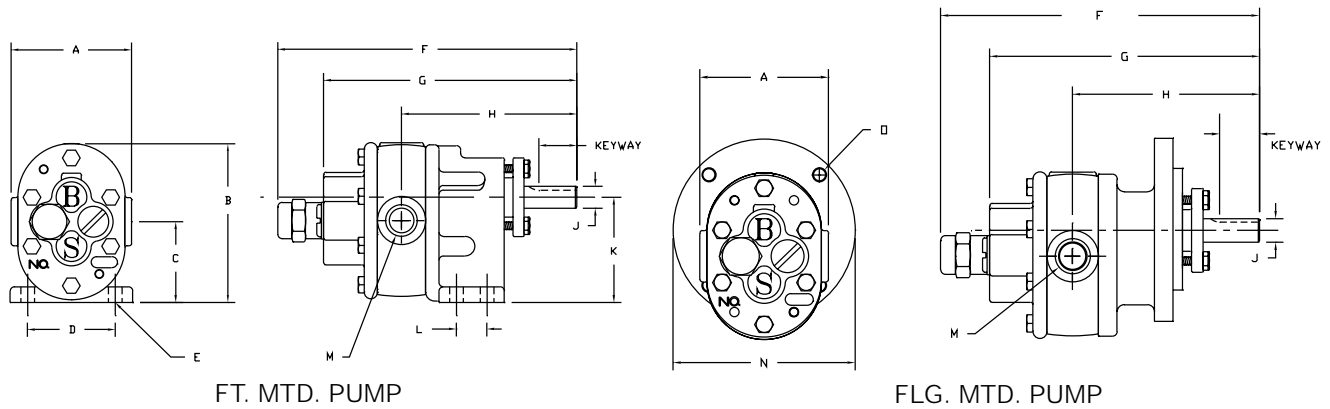

DIMENSIONS (INCHES)

Model	A	B	C	D	E	F	G	H	J	K	L	M	O	Keyway
1	3.00	3.69	1.78	2.00	0.39	7.50	6.25	4.56	0.56	2.38	0.75	3/8	3/8-16	1/8 x 1/16
2	3.44	4.53	2.31	2.50	0.39	8.47	7.22	5.00	0.63	3.00	0.88	1/2	3/8-16	3/16 x 3/32
3	4.44	5.72	2.88	3.00	0.45	10.50	8.88	6.19	0.75	3.88	1.25	3/4	3/8-16	3/16 x 3/32
4	4.44	5.81	2.88	3.00	0.45	11.50	9.88	6.69	0.75	3.88	1.25	1 1/4	3/8-16	3/16 x 3/32

OPERATING CHARACTERISTICS

Model	Displmnt gals. per rev.	Slip gpm/psi	Drive Speed rpm	0 psi		50 psi		75 psi		100 psi		200 psi	
				gpm	hp	gpm	hp	gpm	hp	gpm	hp	gpm	hp
1	.00515	.0022	300	1.5	.02	1.4	.10	1.38	.14	1.3	.18	1.1	.34
			600	3.1	.05	3.0	.20	2.93	.28	2.9	.36	2.7	.66
			900	4.6	.11	4.5	.33	4.47	.35	4.4	.54	4.2	.98
2	.01043	.0023	300	3.1	.04	3.0	.19	2.95	.26	2.9	.34	2.7	.64
			600	6.3	.07	6.1	.34	6.1	.47	6.0	.61	5.8	1.1
			900	9.4	.11	9.3	.48	9.2	.66	9.1	.85	8.9	1.5
3	.01896	.0025	300	5.7	.05	5.6	.28	5.5	.41	5.4	.54	5.2	1.1
			600	11.4	.06	11.3	.47	11.2	.71	11.1	.97	10.9	2.1
			900	17.1	.17	17.0	.83	16.8	1.2	16.8	1.5	16.5	3.2
4	.02980	.0080	300	8.9	.07	8.5	.37	8.3	.57	8.1	.80	--	--
			600	17.9	.22	17.5	.77	17.3	1.1	17.1	1.4	--	--
			900	26.8	.50	26.4	1.3	26.2	1.7	26.0	2.3	--	--

*Delivery and input horsepower are based on liquid viscosity of 300 ssu at speed and pressures shown.

BSM ROTARY GEAR PUMPS

B-SERIES

OPERATING CHARACTERISTICS, 32 SSU LIQUID

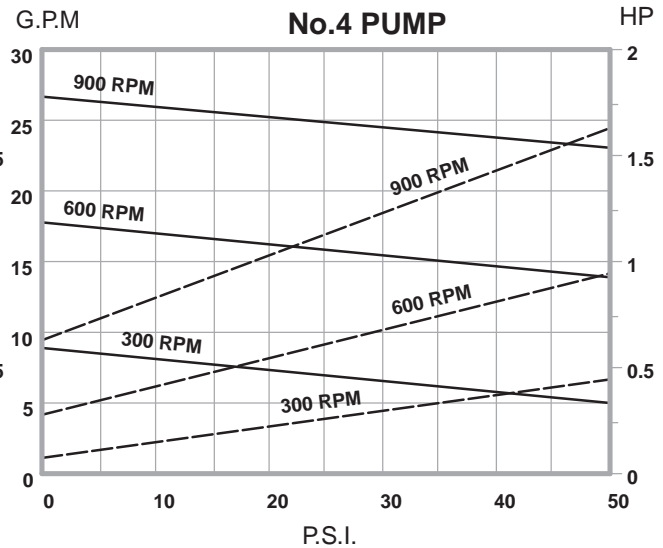
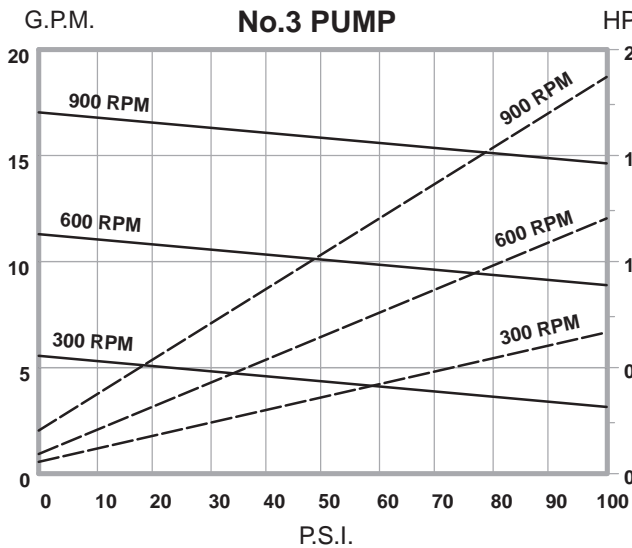
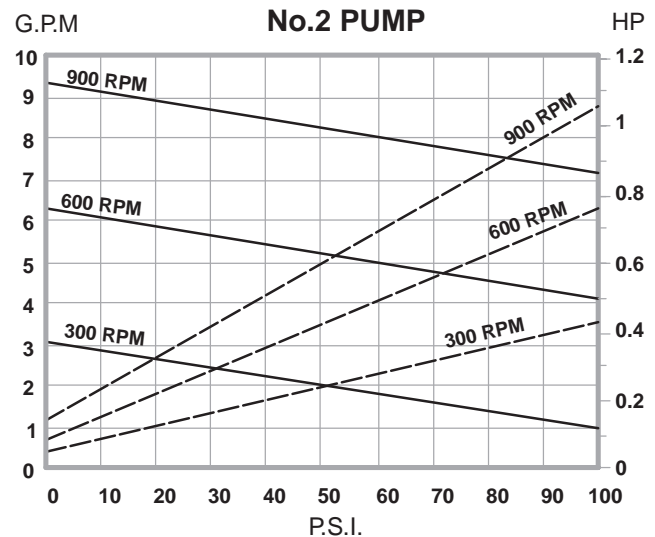
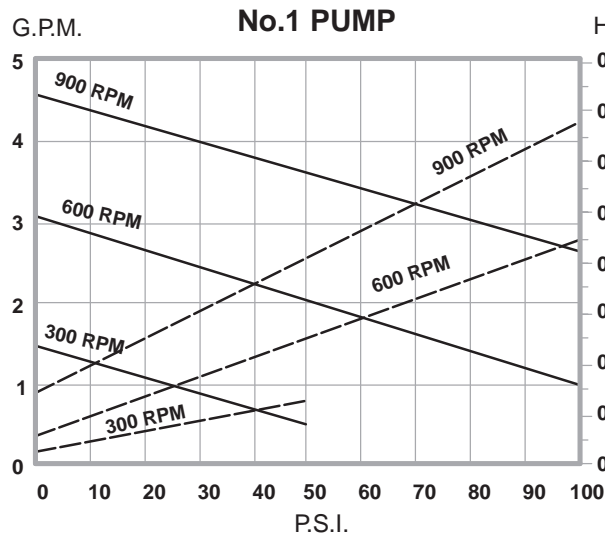

SOLID LINE = GPM
BROKEN LINE = HP

BSM ROTARY GEAR PUMPS

B-SERIES

OPERATING CHARACTERISTICS, 300 SSU LIQUID

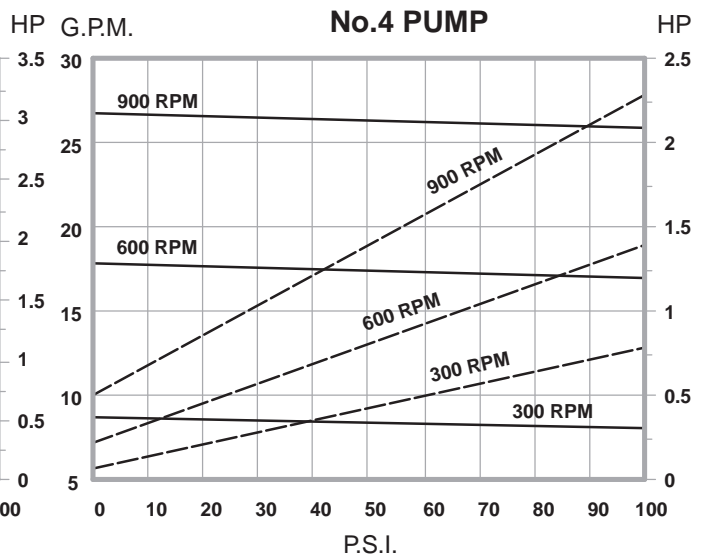
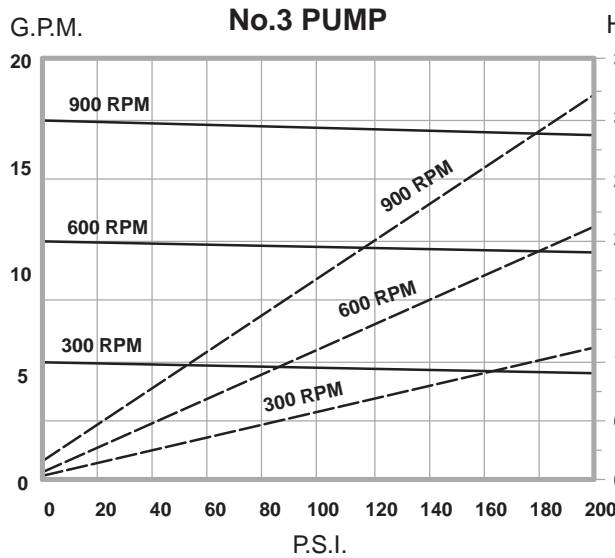
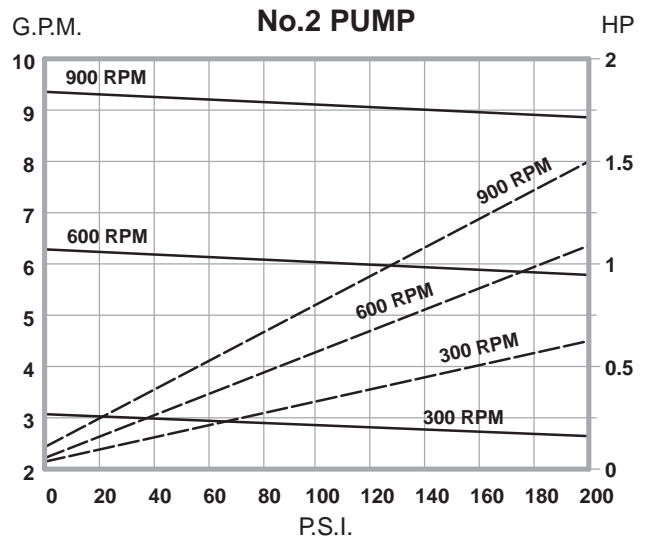
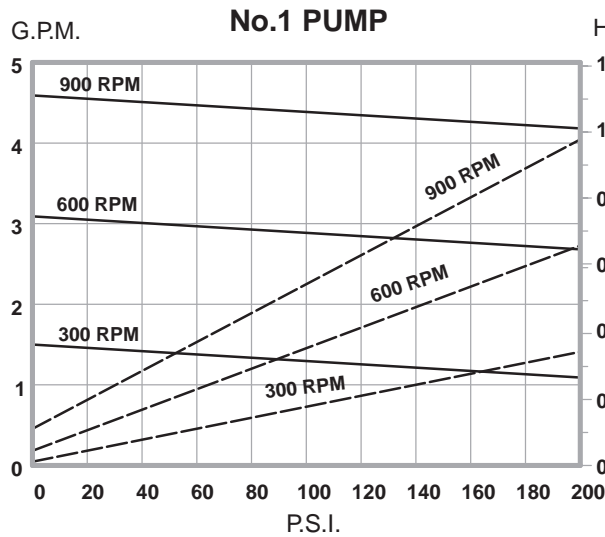

SOLID LINE = GPM
BROKEN LINE = HP

BSM ROTARY GEAR PUMPS

B-SERIES

OPERATING CHARACTERISTICS, 1,000 SSU LIQUID

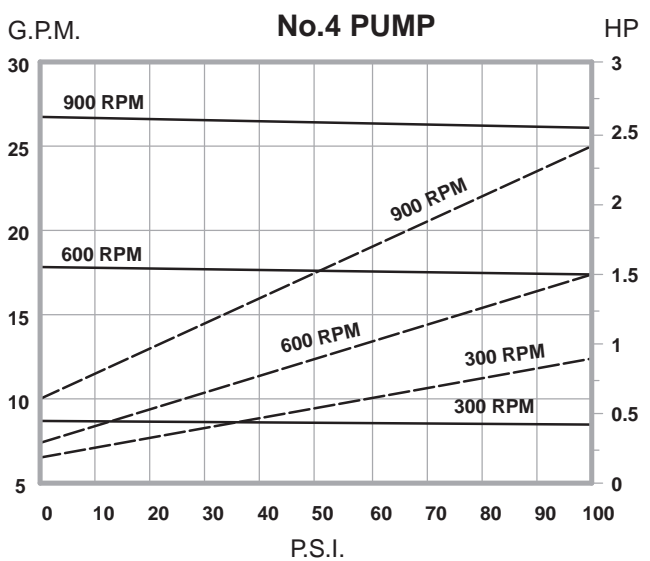
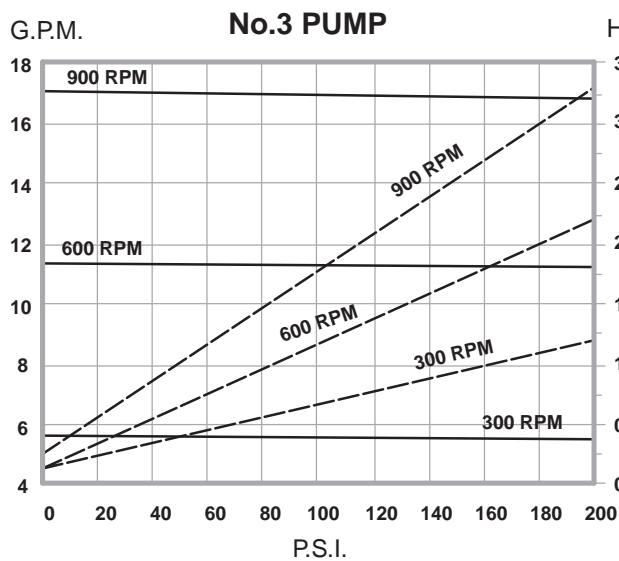
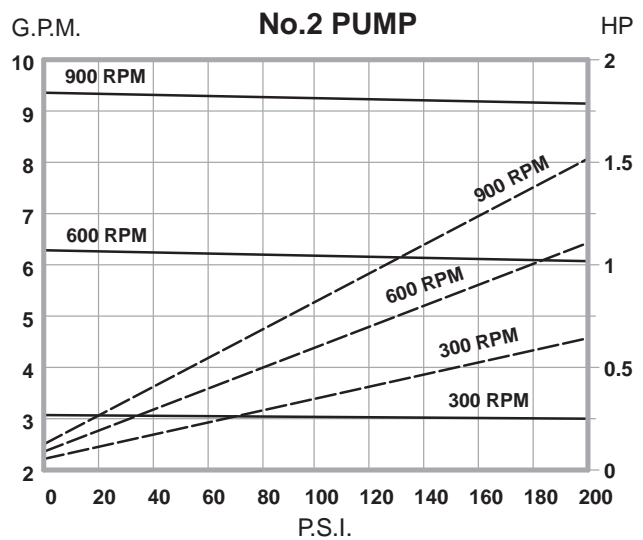
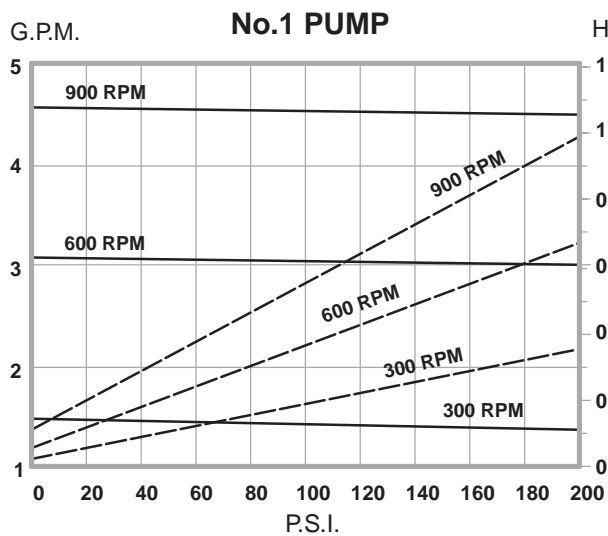

SOLID LINE = GPM
BROKEN LINE = HP

BSM ROTARY GEAR PUMPS

B-SERIES

OPERATING CHARACTERISTICS, 5,000 SSU LIQUID

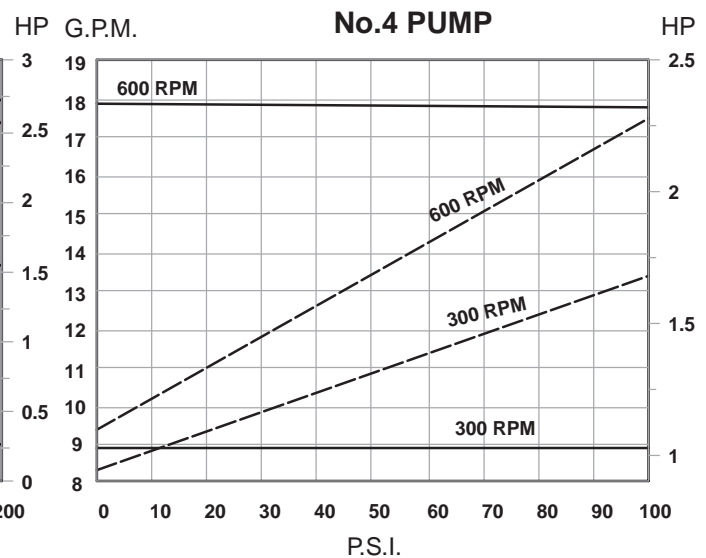
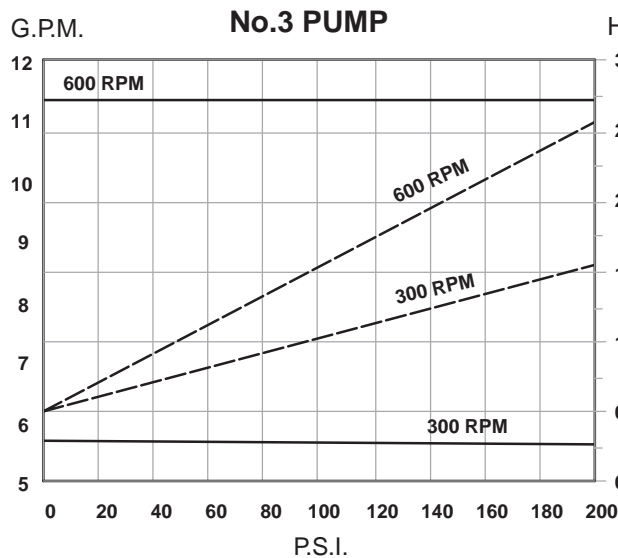
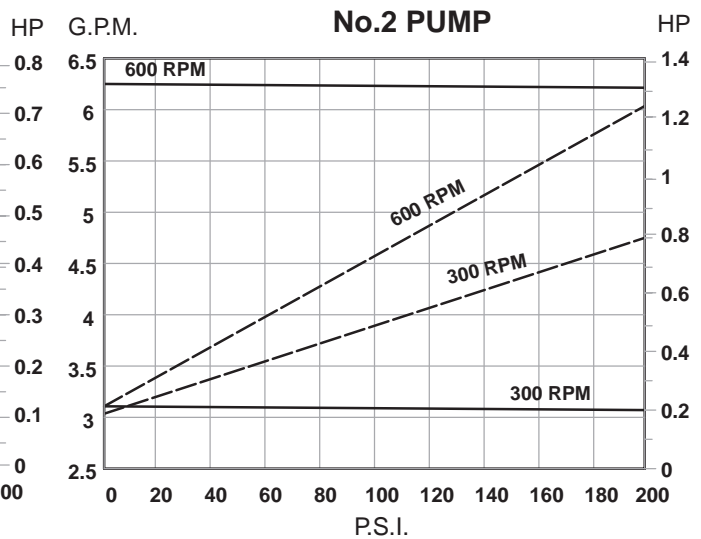
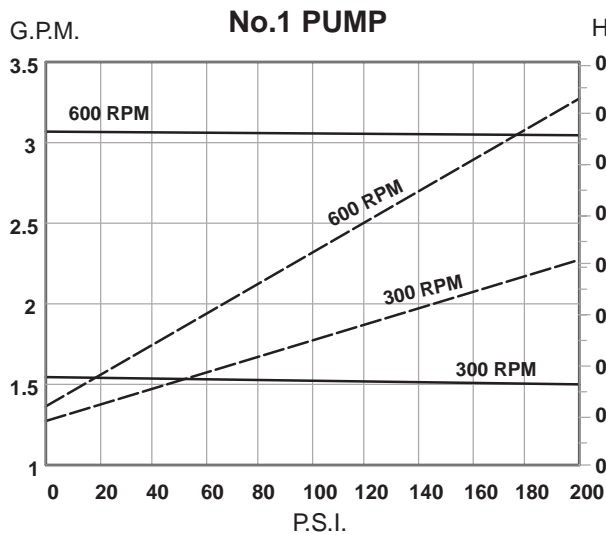

SOLID LINE = GPM
BROKEN LINE = HP

BSM ROTARY GEAR PUMPS

B-SERIES MOTOR DRIVEN ROTARY GEAR PUMPS (A-DRIVE)

BSM B-Series pumps are available direct coupled to a Nema C-Face foot mounted motor. This assembly, referred to as an A-Drive, ensures accurate alignment and requires less space and is less costly than a pump and motor mounted on a baseplate. BSM B-Series Motor Driven Rotary Gear Pumps are available in motor speeds of 860 rpm with capacities to 26.8 gpm and pressures to 200 psi.

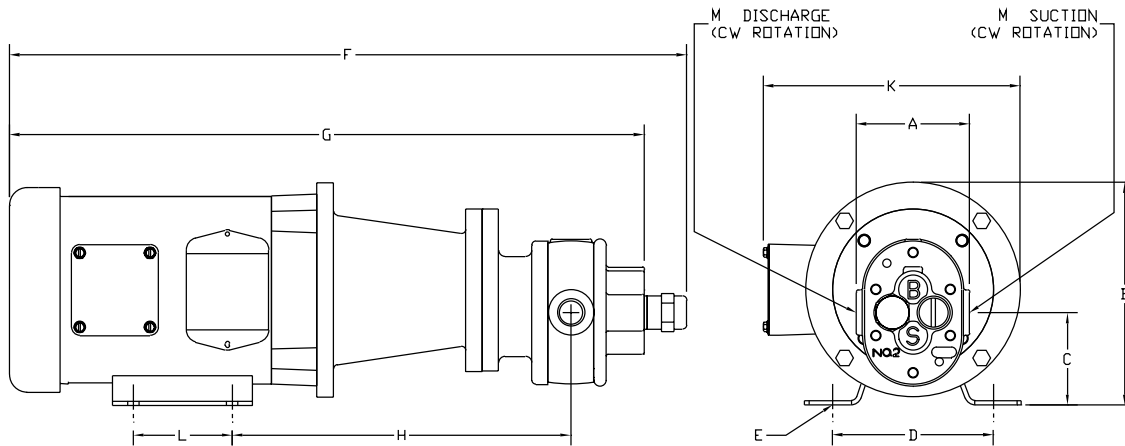

DIMENSIONS (INCHES)

Model No.	Motor Frame	A	B	C	D	E	F	G	H	K	L	M
1-A	56C	3.00	6.88	2.91	4.88	0.34	19.81	18.56	9.81	8.31	3.00	3/8
	145TC	3.00	6.88	2.91	5.50	0.34	21.53	20.28	10.12	8.56	5.00	3/8
	182TC	3.00	8.69	3.91	7.50	0.41	23.12	21.87	11.75	9.81	4.50	3/8
2-A	56C	3.44	6.88	2.81	4.88	0.34	20.78	19.53	10.25	8.31	3.00	1/2
	145TC	3.44	6.88	2.81	5.50	0.34	22.50	21.25	10.56	8.56	5.00	1/2
	182TC	3.44	8.69	3.81	7.50	0.41	24.09	22.84	12.19	9.81	4.50	1/2
	184TC	3.44	8.69	3.81	7.50	0.41	25.09	23.84	12.19	9.81	5.50	1/2
3-A	56C	4.44	6.88	2.50	4.88	0.34	22.82	21.19	11.43	8.31	3.00	3/4
	145TC	4.44	6.88	2.50	5.50	0.34	24.54	22.91	11.75	8.56	5.00	3/4
	182TC	4.44	8.69	3.50	7.50	0.41	26.13	24.50	13.37	9.81	4.50	3/4
	184TC	4.44	8.69	3.50	7.50	0.41	27.13	25.50	13.37	9.81	5.50	3/4
	213TC	4.44	10.25	4.25	8.50	0.41	29.04	27.41	14.25	12.16	5.50	3/4
	215TC	4.44	10.25	4.25	8.50	0.41	30.54	28.91	14.25	12.16	7.00	3/4
4-A	145TC	4.44	6.88	2.50	5.50	0.34	25.54	23.91	12.25	8.56	5.00	1 1/4
	182TC	4.44	8.69	3.50	7.50	0.41	27.13	25.50	13.87	9.81	4.50	1 1/4
	184TC	4.44	8.69	3.50	7.50	0.41	28.13	26.50	13.87	9.81	5.50	1 1/4
	213TC	4.44	10.25	4.25	8.50	0.41	30.04	28.41	14.75	12.16	5.50	1 1/4
	215TC	4.44	10.25	4.25	8.50	0.41	31.54	29.91	14.75	12.16	7.00	1 1/4

BSM ROTARY GEAR PUMPS

B-SERIES BASE MOUNTED ASSEMBLIES (D-DRIVE)

BSM B-Series pumps are available as base mounted pump and motor assemblies. Each assembly includes the base, flexible coupling, coupling guard, riser blocks (if required), lifting eye-bolts, and mounting hardware. The fabricated steel or channel steel bases are available with optional features such as drip-lip construction, drain plugs, mounting lugs, casters, etc..

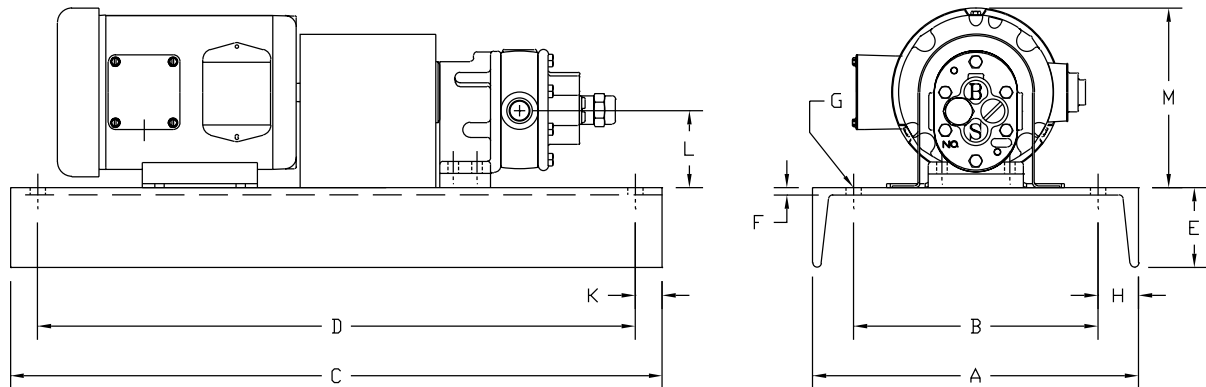

DIMENSIONS (INCHES)

Model No.	Motor Frame	A	B	C	D	E	F	G	H	K	L	M
1-D	56C	12.00	9.00	24.00	22.00	2.94	0.28	0.56	1.50	1.00	2.91	6.88
	145TC	12.00	9.00	26.00	24.00	2.94	0.28	0.56	1.50	1.00	2.91	6.88
	182TC	12.00	9.00	30.00	28.00	2.94	0.28	0.56	1.50	1.00	3.91	8.69
2-D	56C	12.00	9.00	24.00	22.00	2.94	0.28	0.56	1.50	1.00	2.81	6.88
	145TC	12.00	9.00	26.00	24.00	2.94	0.28	0.56	1.50	1.00	2.81	6.88
	182TC	12.00	9.00	30.00	28.00	2.94	0.28	0.56	1.50	1.00	3.81	8.69
	184TC	15.00	12.00	32.00	30.00	3.41	0.41	0.56	1.50	1.00	3.81	8.69
3-D	56C	12.00	9.00	24.00	22.00	2.94	0.28	0.56	1.50	1.00	2.50	6.88
	145TC	12.00	9.00	26.00	24.00	2.94	0.28	0.56	1.50	1.00	2.50	6.88
	182TC	12.00	9.00	30.00	28.00	2.94	0.28	0.56	1.50	1.00	3.50	8.69
	184TC	15.00	12.00	32.00	30.00	3.41	0.41	0.56	1.50	1.00	3.50	8.69
	213TC	15.00	12.00	34.00	32.00	3.41	0.41	0.56	1.50	1.00	4.25	10.25
	215TC	15.00	12.00	36.00	34.00	3.41	0.41	0.56	1.50	1.00	4.25	10.25
4-D	145TC	12.00	9.00	26.00	24.00	2.94	0.28	0.56	1.50	1.00	2.50	6.88
	182TC	12.00	9.00	30.00	28.00	2.94	0.28	0.56	1.50	1.00	3.50	8.69
	184TC	15.00	12.00	32.00	30.00	3.41	0.41	0.56	1.50	1.00	3.50	8.69
	213TC	15.00	12.00	34.00	32.00	3.41	0.41	0.56	1.50	1.00	4.25	10.25
	215TC	15.00	12.00	36.00	34.00	3.41	0.41	0.56	1.50	1.00	4.25	10.25